

# Metalwërks<sup>®</sup> Column and Beam Cladding

Metalwërks<sup>®</sup> Column and Beam Cladding is engineered to provide expanded design flexibility. Beyond typical cylindrical or square tubular enclosures, Metalwërks Column and Beam Cladding takes on virtually any geometrical form as it is manufactured from solid metal plate.

Perfect for enclosing any vertical, sloped, or horizontal structural member – concrete, structural steel, and stud backup – Metalwërks Column and Beam Cladding panels beautifully integrate with Metalwërks plate wall systems.



## FEATURES AND BENEFITS

- Integrate with Metalwërks plate wall systems or stand-alone applications
- Typically manufactured in solid 0.125" (3.18 mm) or 0.188" (4.78 mm) thick aluminum and 16-12 gauge stainless steel (smooth and textured)
- More abuse resistant than gypsum- or fiberglass-based products or aluminum composite material.
- Can be custom formed to adapt to all types of geometric designs, including curves with radii down to 6"
- Non-Combustible: minimal smoke or fuel contribution
- Avoids NFPA 285 complications by avoiding thermo-plastic cores
- All panel systems are reinforced/stiffened to resist deflection limits
- Vertical butt joints or open 0.625" reveals with recessed batten strip, or backer rod and sealant
- Panels custom manufactured and not limited by minimum production runs
- Metalwërks supplies engineered supports for the enclosure products
- 100% recyclable and manufactured from materials with high post-consumer/ industrial content which can contribute to LEED credits

- Virtually limitless palette of colors, finishes, and textures
- Aluminum: high performance finishes are post applied for the highest quality of coverage and uniformity
- Available in no-VOC powder coated finishes. Non-toxic and non-combustible.
- Finish warranties up to 20 years (coated aluminum). Consult Metalwërks for limitations

## USES

- Enclosures for exposed columns, beams, or pilasters
- Custom duct enclosures
- Enhanced interior lobby aesthetics
- Glazed or non-glazed curtain wall applications
- Available with articulations, reveals and appliqué
- High durability for high traffic areas and transit centers

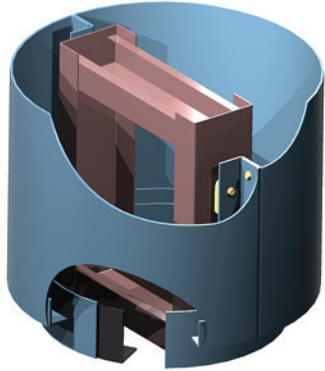

**VERTICAL FORMED JOINT**

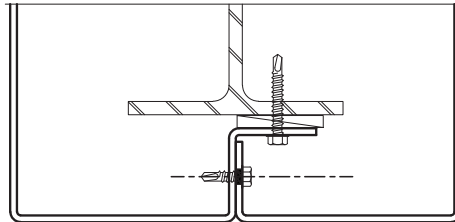

**VERTICAL FORMED JOINT WITH REVEAL**

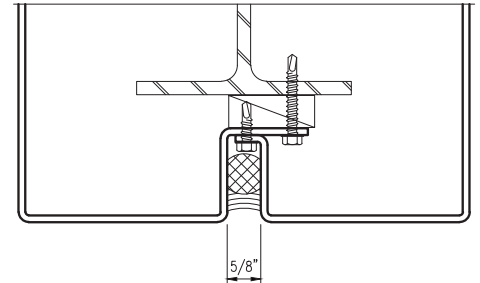

**VERTICAL CURVED JOINT**

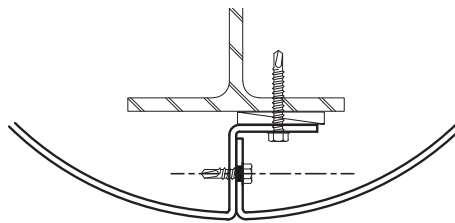

**VERTICAL CURVED JOINT WITH REVEAL**

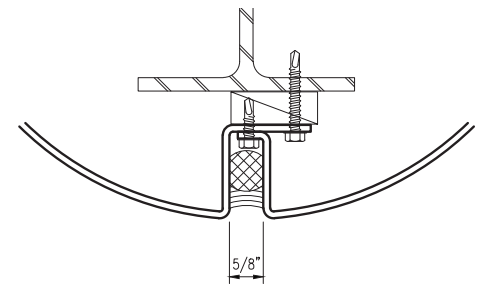

## METAL SUBSTRATE AND FINISH OPTIONS

### ALUMINUM PLATE

#### 3003-H14 aluminum alloy-temper

**Thickness:** 0.125" (3.18 mm) standard, 0.188" (4.78 mm), 0.25" (6.35 mm) options. Consult Metalwërks for additional options.

**Finishes:** Kynar® or architectural TGIC Polyester powder coating

### STAINLESS STEEL

**T304 or T316** for enhanced corrosion resistance

**Thickness:** 14 gauge (0.078") (1.98 mm) standard, 12 gauge (0.109") (2.78 mm), 16 gauge (0.063") (1.60 mm) options

**Finishes:** #4, #6, #8, and non-directional satin in smooth or custom embossed patterns

### ZINC

Consult with Metalwërks for options

Zinc is a natural metal which has specific properties that will limit its use. It must be adequately drained, ventilated and weeped when used in exterior applications to prevent excessive corrosion. Please consult Metalwërks for the appropriate uses for your project design.

## PANEL SIZES

**Profiles: Curved and Formed:** 12" (305 mm) to 66" (1,676 mm)\*

**Lengths: Curved:** 12" (305 mm) to 192" (4,877 mm)\*

**Formed:** 12" (305 mm) to 240" (6,096 mm)\*

**Depth:** Varies

\* Maximum panel size depends upon plate material, gauge, finish, and geometry

## PANEL WEIGHT

Consult with Metalwërks for options

## SHAPES OR PROFILES

- Round or square
- Elliptical & racetrack ovals
- Conical or tapered
- Non symmetrical articulations

## ACCESSORIES

- Support framing
- Articulated capitals and bases
- "Snug fit" spring loaded ceiling closures
- Welded mitered sections, end caps, base reveals beam penetrations
- Access doors
- Sloped base, ceiling terminations
- Curved base, ceiling terminations
- Extruded or formed appliqué.
- Accent color reveals

## WARRANTY

**Material & Workmanship:** 1-year standard, with 2- or 5-year options

**Finish Integrity:** 10-year standard and up to 20-year for coated aluminum